

AREA STATEMENT AND POPULATION CHART -(ALREADY SANCTION) PHASE 1						
BUILDING DESCRIPTION	AREA CALCULATION	POPULATION STATEMENT				
DWG TYPE	DESCRIPTION	GROUND COVERAGE (sqm)	FAR (sqm)	NO. OF APARTMENTS	POPULATION BREAK UP	TOTAL POPULATION (Main+ Service)
VER EAST	G+27	5,563.732 <i>ALREADY SANCTIONED</i>	62973.676	239	1195	10% of the main Dwelling Units = 433 x 10 / 100 = 44 Units Hence Service Population = 44 x 2 = 88 Person / Room. EWS Population = 77x2= 154 Person
VER WEST	G+34			194	970	
CLUB	G+1					
SHOPPING	G					
EWS	S+4	629.015	1745.311	77	242	
IND TOTAL		6,092.747	64718.987	510	2185	242

AREA STATEMENT AND POPULATION CHART -(REVISED SANCTION) PHASE 2							
BUILDING DESCRIPTION	AREA CALCULATION	POPULATION STATEMENT					
BUILDING TYPE	DESCRIPTION	GROUND COVERAGE (sqm)	FAR (sqm)	NON FAR (sqm)	NO. OF APARTMENTS	POPULATION BREAK UP	TOTAL POPULATION (Main+ Service)
TOWER 1A	G+34	1,952.630	25936.847	52920.015	320	1600	10% of the main Dwelling Units = 320 x 10 / 100 = 32 Units Hence Service Population = 32 x 2 = 64 Person / Room. EWS Population = 56x2= 116Person
CLUB	G						
SHOPPING	G						
NURSERY SCHOOL	G	244.3		270.2	58	180	
EWS	G+3	731.313	1552.635	5933.719	58	180	
GRAND TOTAL		2,928.243	27489.482	59123.03	378	1600	180

AREA STATEMENT AND POPULATION CHART -(PHASES 4 & 5 SANCTION)							
BUILDING DESCRIPTION	AREA CALCULATION	POPULATION STATEMENT					
DWG TYPE	DESCRIPTION	GROUND COVERAGE (sqm)	FAR (sqm)	NON FAR (sqm)	NO. OF APARTMENTS	POPULATION BREAK UP	TOTAL POPULATION (Main+ Service)
3.1	G+36	1,426.762	24723.3	31758.88	134	670	
3.2	G+36	1,488.821	25982.709	33587.29	218	1090	
3.3	G+43	1,488.821	25982.709	33587.29	218	1090	
B.O	G+48	1,177.130	32748.78	41416.02	449	2245	
WTS	3 LEVEL	973.090	1946.180	2432.735			
MEZZANINE (06 see 2.8.3)	G+1			1004.194			
SCHOOL	G+2	1,232.480	3812.112				10% of the main Dwelling Units = 1048 x 10 / 100 = 105 Units Hence Service Population = 105 x 2 = 210 Person / Room. EWS Population = 180x2= 370Person
US BUILDING	G	671.2	711.82				
ROOM	B+D+4	2,299.690	10987.872				
ROOM	G	204.25	204.25				
IT SCHOOL	G	244.3	244.3				
FRSE	S+7	317.907	4317.335	5691.051	188	582	
IND TOTAL		11,378.261	123709.834	263559.586	1235	6245	582

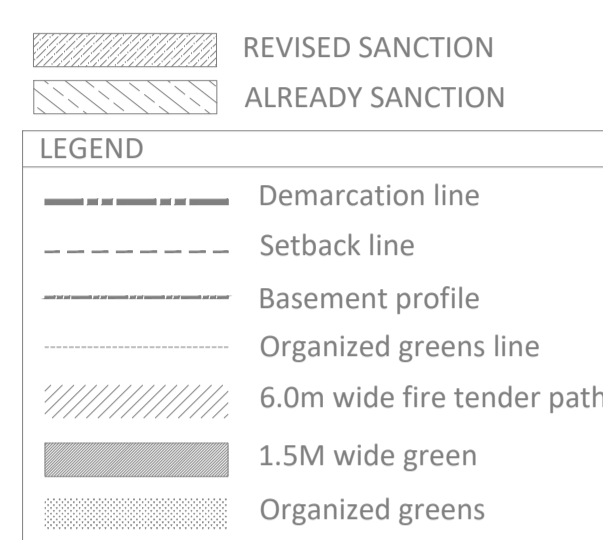

- NOTES:
- All lifts shall have 100% power back up
 - All Electrical installations shall be as per NBC provisions
 - Fire fighting/Safety provisions will be as per prevalent NBC provisions
 - Roof slab of Upper basement is designed to take Fire Tender load

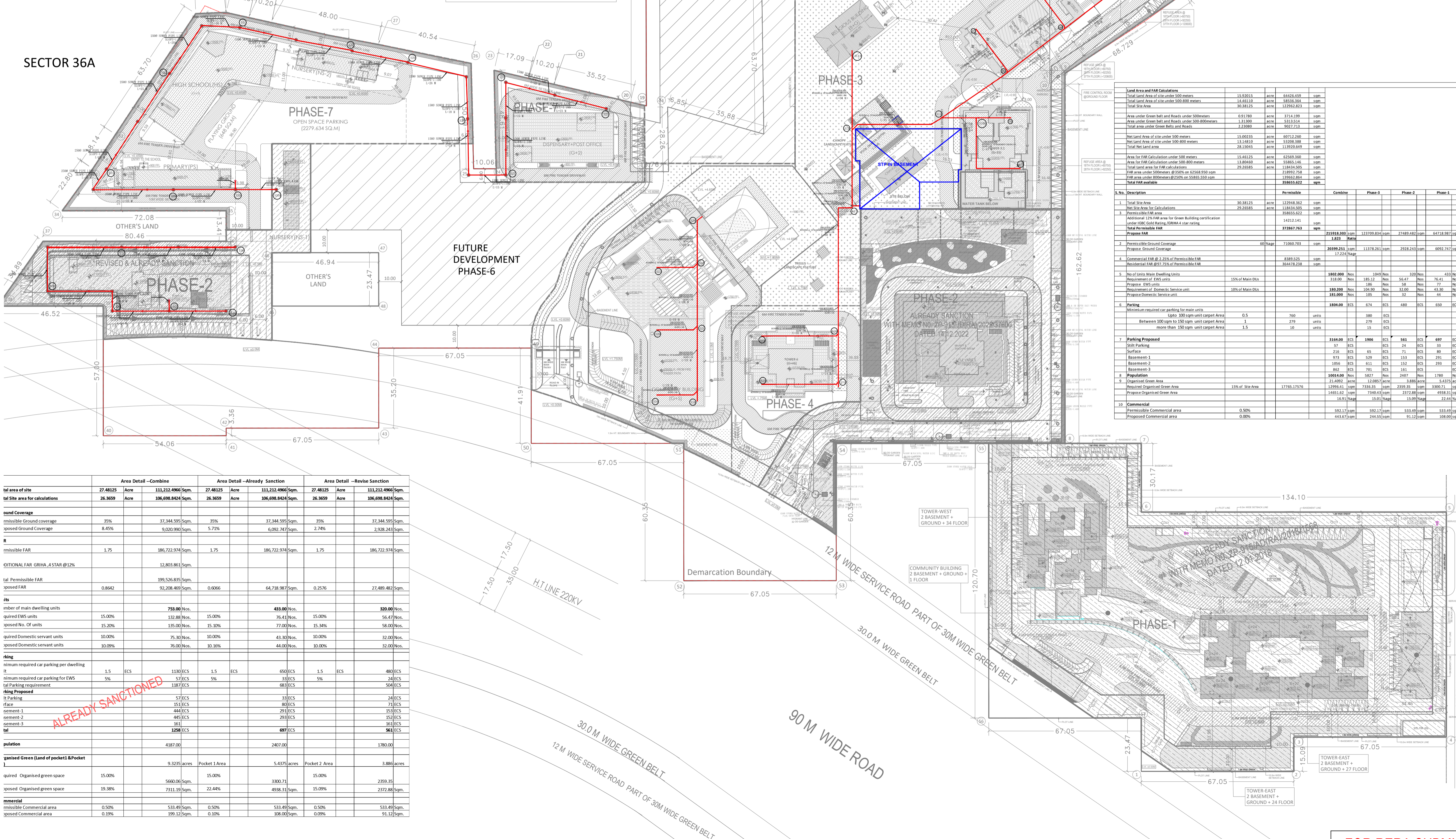

S. No.	Description	Permissible	Proposed	Phase 3	Phase 2	Phase 1
1	Total Site Area	30,381.25	12,294.92			
2	Net Site Area for Calculations	29,205.85	11,815.50			
3	Permissible FAR	14212.141	32865.032			
4	Commercial FAR @ 2.5% of Permissible FAR	3553.035	8216.258			
5	Residential FAR @ 75% of Permissible FAR	10659.096	24648.774			
6	Net of Urban Main Dwelling Units	1802.00	1906	563	497	433
7	Population	10914.00	11812	3677	2967	2467
8	Organized Green Area	17365.1376	1455.02	15.00	15.00	15.00
9	Proposed Organized Green Area	1455.02	15.00	15.00	15.00	15.00
10	Commercial Permissible Commercial area	0.50%	50.17	50.17	50.17	50.17
11	Proposed Commercial area	0.00%	443.87	443.87	443.87	443.87

	Area Detail -Combine	Area Detail -Already Sanction	Area Detail -Revise Sanction
tal area of site	27.48125 Acre	111.212.4966 Sqm	27.48125 Acre
tal Site area for calculations	26.3659 Acre	106,698.8424 Sqm	26.3659 Acre
Ground Coverage			
missible Ground coverage	35%	37,344.595 Sqm	35%
proposed Ground Coverage	8.45%	9,020.990 Sqm	5.73%
R			
missible FAR	1.75	186,722.974 Sqm	1.75
OPTIONAL FAR GRINA_ASTAR@12%		12,803.861 Sqm	
tal Permissible FAR	0.8642	199,526.835 Sqm	0.2576
proposed FAR		92,208.469 Sqm	0.2576
its			
umber of main dwelling units		753.00 Nos.	433.00 Nos.
quired EWS units	15.00%	132.88 Nos.	15.00%
quired No. Of units	15.20%	135.00 Nos.	15.34%
quired Domestic servant units	10.00%	75.30 Nos.	10.00%
quired Domestic servant units	10.00%	75.30 Nos.	10.00%
ing			
imum required car parking per dwelling	1.5	1130 EWS	1.5
imum required car parking for EWS	5%	57 EWS	5%
al Parking requirement		1187 EWS	
ing Proposed			
ace		33 EWS	24 EWS
ement-1		44 EWS	33 EWS
ement-2		44 EWS	33 EWS
ement-3		30 EWS	30 EWS
tal		158 EWS	158 EWS
ulation		4187.00	2407.00
anized Green (Land of pocket1 & Pocket 2)		9.3235 acres	5.4375 acres
quired Organized green space	15.00%	5660.06 Sqm	15.00%
quired Organized green space	10.38%	7311.19 Sqm	22.44%
mmercial			
missible Commercial area	0.50%	533.48 Sqm	0.50%
proposed Commercial area	0.00%	199.12 Sqm	0.00%

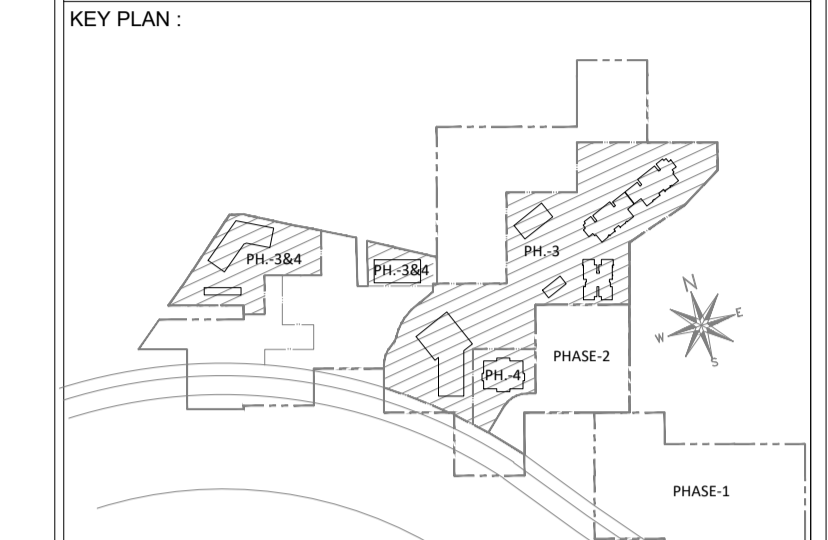

PROJECT ARCHITECT-
rajeev agarwal architects
1-1963, chitaranjan park
new delhi - 110019
tel: 011-42026648
website: www.rajeevagarwal.com

STRUCTURE
NNC DESIGN INTERNATIONAL
NNC CONSULTING STRUCTURAL ENGINEERS
G-70, 3rd FLOOR, HARVAT PEARL, SECTOR 36A, Gurgaon
MAIN SAKSHI VIBAR ROAD, GURGAON, HARYANA
PHONE NO: +91-11-9990745/7/8 FAX: 99907028
E-Mail: nnc_consultants@hotmail.com
Web : www.nncdesigninternational.com

MEP Consultants
PDA
150, 2nd Floor, F.I.E. Patparganj
Industrial Area, Delhi - 110092.
M-971071620, Toll-Free:
+91-11-4248031-2

PROJECT LANDSCAPE CONSULTANTS
Greenbox Designs
P-123, DLF City Phase 2
Gurgaon
Haryana, India

PROJECT TITLE
REVISED BUILDING PLANS OF GROUP HOUSING COLONY
AREA MEASURING 30.38125 ACRES
(30.08 ACRES UNDER LICENCE NO. 39 OF 2013 DATED 04.08.2013 AND 25.10 ACRES UNDER LICENCE NO. 85 OF 2014 DATED 08.08.2014) GRANTED FOR 2.38125 ACRES AND ADDITIONAL AREA MEASURING 2.90 ACRES/LICENCE NO. 166 OF 2023 DATED 18.08.2023 IN SECTOR-36-A, GURGAON MANESAR URBAN COMPLEX BEING DEVELOPED BY KRISUMI CORPORATION PVT. LTD.

ARCHITECT'S SIGNATURE / STAMP :

STRUCTURE CONSULTANT SIGNATURE / STAMP :

OWNER SIGNATURE / STAMP :

DRAWING TITLE : **SITE PLAN**
SEWERAGE LAYOUT FOR RERA

SCALE: 1:500
DATE: 15.01.2024
DRAWING NO.: SITE-PL-002
RELEASED FOR:
 INFORMATION
 EIA
 TENDER
 ADVANCE COPY
 SUBMISSION DRG
 GFC

FOR RERA SUBMISSION

AREA=23.172 ACRES